

MWS1A-C-PRM-VFC | PRM switching, long range, IP40, ceiling, back box mounted, microwave, presence detector, volt free contact



Key Product Features:

- Presence detection
- Volt free contacts
- Easily setup using the optional UHS5 infrared handset – no need to remove unit to re-program
- Detection range of up to 25 metres
- Suitable for heating and ventilation applications
- Compatible with European back boxes
- Fixing screw cap covers – smooth plate finish
- 5 year warranty

Key Functions:

- User handset available to control on/off and lux levels
- Suitable for all lighting types

Detection pattern

high < sensitivity > low

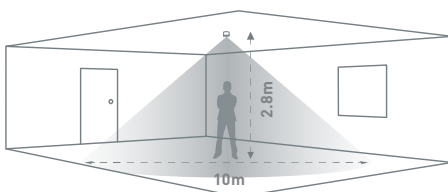

Dimensions (mm)

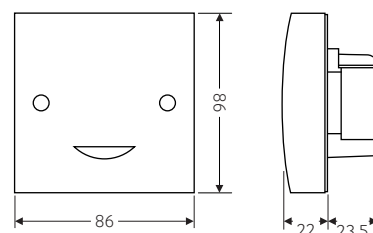





Technical Data

Part Code	MWS1A-C-PRM-VFC
Weight	0.100kg
Supply Voltage AC	230 VAC +/- 10%
Supply frequency	50Hz
Power consumption parasitic	790mW
Terminal capacity	2.5mm ²
Min load	100mA
Max load:	
Incandescent lighting	3A
Fluorescent lighting	3A
Compact fluorescent lighting	3A
LED lighting	3A
Resistive heaters	6A
Fans and ventilation equipment	3A
Low voltage supply with open collector output	3A
Time out range	10 seconds to 99 minutes
Max power factor correction capacitance	40µF
Working temperature range	-10 to 50°C
Humidity	5 to 95% non-condensing
Material (casing)	Flame retardant ABS
Insulation class	Class 2
Microwave frequency	10.587GHz
IP rating	40
Compliance	 EMC-2004/108/EC LVD-2006/95/EC

Accessories and Associated Products

Part Number	Description
 UHS5	Compact, programming/commissioning handset

	<p>CP Electronics A Business unit of Legrand Electric Limited, Brent Crescent, London NW10 7XR, UK t. +44 (0)333 900 0671 info@cpelectronics.co.uk</p>	<p>Important notice: This device should be installed by a qualified electrician in accordance with the latest edition of the IEE Wiring Regulations and the applicable Building Regulations. Due to our policy of continual product improvement CP Electronics reserves the right to alter the specification of this product without prior notice.</p> <div style="display: flex; justify-content: space-between; align-items: center;"> <div data-bbox="1284 1948 1492 2004">  </div> <div data-bbox="1292 2038 1484 2105">  </div> </div>
<p>www.cpelectronics.co.uk</p>	<p>connect with us </p>	